



**DIFFERENCE**

EXCEPTIONAL ELDERLY CARE RESIDENCE



## ENJOY YOUR LIFE

Honestly we believe that elderly people deserve to enjoy life until the last day and our goal is to offer a retirement lifestyle to make residents and their guests feel truly at home.

You will have your independent lifestyle with the security of knowing our staffs provides caring personal service, for those times you may require assistance.

At "DIFFERENCE" you'll have the opportunity to do things you currently enjoyed or to discover new interests in an environment that is comfortable and secure. New friendships will be made, including people from other countries, and old ones will be maintained while enjoying our many indoor and outdoor facilities.

[WWW.DIFFERENCERESIDENCE.COM](http://WWW.DIFFERENCERESIDENCE.COM)

# FEEL THE DIFFERENCE

The "DIFFERENCE" the exceptional residence for senior citizen is located in the Bangsarea area, approximately 25 km south of Pattaya. The well-known Khao Chi Chan with the famous laser-sculptured Buddha image, Silver Lake Vineyard; and Wat Yan Historical Park are only a few kilometres away as are Nong Nooch Tropical Park and the charming fishermen villages Ban Ampoe and Bangsarea with plenty of seafood restaurants and nice beaches.



The "DIFFERENCE" will set new examples of achievement for quality standards in living during the cherished third phase of life. The residence offers the highest possible level of service for private residences in an ambiance similar to that of a hotel resort in a warm and friendly atmosphere where care and attention are the main priorities.

The "DIFFERENCE" is a residence for senior citizen and therefore many of the residents will be older. Whatsoever age is of no concern for residents, their spouses or partners living with a resident as there is no minimum age required.

The Residence will anyway not appear as a place where only elderly people live. With 280 staff and 250 of them between 20 and 35 years old the residence will be transformed into a lively place with older and younger people around. Beside university students and school children will be regularly invited to exchange ideas. "Young people meet experienced people and vice versa" will be the motto. The Residence offers daily shuttle-bus services to the Wat Yan Historical Park, the Bangsarea and Ban Ampoe beach and the centre of Pattaya and also has van with driver for hire.

Parking facilities for motorbike, bikes and car's are available at the entrance to the residence however driving within the residence is only possible by using battery driven golf carts operated by our residence drivers.

Every apartment, villa or terrace house is equipped with a telephone connected to reception, restaurant and clinic and has outside connection incl. international calls via the operator. Emergency buttons are in every apartment or house as well as in elevators, restaurants, library etc. to assure that assistance is available within minutes.

# LIVING IN THAILAND

The kingdom is for quite a long time well-known as investment place and as a travel destination and undoubtedly a safe country. A constitutional monarchy with a king highly respected by his people, a stable political system and a quite stable currency are other benefits Thailand has to offer. The costs of living are increasing constantly in the Western world, isolation, a rather unpleasant weather situation and above all older people are not very well treated as they would deserve; different from Thailand where older people are respected.

Due the desolate care situation in Europe, many people are forced to find a new living environment. Furthermore typical age-related illnesses such as gout, rheumatism, arthritis, etc. contribute to the fact that older people are leaving Europe and move to warmer countries. This leads to an ever-increasing demand - especially among people from Western countries - to make this suitable and cost-effective place their new home.



# THE CONCEPT

Apartments, villas and terrace houses can be rented or purchased by the resident; however there will be no ownership of such property only the right of use of the specific unit for the time (similar to ownership structures in Western countries) as long as the resident/s are alive; however a minimum of 30 years of living rights will be stated.

In the event that a resident passes away before that time any heir will be compensated with a certain percentage of the original purchase price per year left. The heir has as well the option to continue living as a resident provided that he/she agree to the conditions or keep the property with the management company and enjoy a steady rental income.

Residents who are married or having a common law marriage and are living together in the Residence are entitled to continue to stay at the purchased apartment, terrace house or villa under the same conditions as before if the partner passes away.

All residents will be members of the “DIFFERENCE CLUB” and can choose between 4 different types of membership cards (Classic Card, Silver Card, Gold Card and Platinum Card) with different service packages according to the needs of residents. Payments will be on a monthly basis. The service is also available for couples were one partner enjoys a discount on the membership fee or can choose a different membership card.

Payments for services not included in the membership and/or purchase of goods, food etc. will be made by using the Residence Debit Card and charged on a monthly basis.



# THE PROJECT

Different from most retirement homes in western countries the “DIFFERENCE” offers living in a village style environment embedded in a landscaped park with many trees, ponds, waterfall, garden and so on.

The residence built on 70 Rai (112,000 square meters) of land consists of two 4-storey apartment building with lobby, office, mini mart, a beautiful designed in-door garden, roof garden with swimming pool and roof bar, 4 elevators; 3-storey buildings a combination of terrace houses and apartments and villas.

Four swimming-pools, gym, craft room, restaurants, cafe bar and pub, library with reading area and internet facilities, laundry, massage and spa, hair dressing salon, minimart and VIP area; and on top a state of the art clinic with integrated pharmacy and inpatient facilities are provided for the residents.

Top positions in the Medical Department are held by doctors from Germany.

The entire residence is suitable for handicapped residents; every apartment or house is accessible by wheelchairs and provides a smoke free environment.

The total project consists of 530 units; 150 apartments, 20 villas and twenty 3-storey buildings a combination of terrace houses and apartments with 200 terrace houses and 160 apartments which can be occupied either by a single resident or a couple.



# OUR SERVICES



Doctor on duty 24 hours.  
Nurse Service 24 hours.  
Ambulance on standby 24 hours.  
Telemedicine Monitoring 24 hours



Residence Pharmacy.



Special area designed as Nursing Home for residents with dementia parkinson or similar symptoms.



Room Service 24 hours.



Reception Service 24 hours.



Movie-on-demand service in all apartments, terrace houses and villas.



Housekeeping & Laundry Service.



Linen and towel service (changed 3 times a week).



Minimart 24 hours



Fitness Trainer



Massage and Spa



Activity Director



Life guards on all four swimming pools



Booking of flights, tours or daytrips, tickets for attraction as Tiffany Alcazar etc. can be arranged by our tour desk.



Payment service by using Residence Debit Card.



Money exchange counter (local bank) and ATM service.



Retirement Visa including renewal free of charge.



Free transportation within the residence by battery-driven golf carts.



Free daily shuttle service to Wat Yan Historical Park, Bangsarea and Ban Ampoe Beach and Pattaya city centre.



Bicycles for rent.



Minibus with driver for rent.

# FREQUENT QUESTIONS AND ANSWERS

Q: WHAT HAPPENS IF I AM ILL AND CAN'T GO TO THE RESTAURANT?

A: The Residence offers 24 hours room-service; you just have to make a phone call!

---

Q: IF I DEPEND ON SPECIFIC MEDICATION TO BE TAKEN ON A REGULARLY BASIS AND MAYBE UNPLEASANT TIME IS THERE ASSISTANCE SO I WANT FORGET?

A: Provided that the medical department has knowledge about it such kind of assistance can be arranged!

---

Q: CAN I HAVE AT ANY TIME ASSISTANCE FROM A DOCTOR OR NURSE OR BOTH?

A: The answer is yes however it might be subject to fees depending on your Club Member status?

---

Q: AS A PLATINUM MEMBER DO I HAVE A SELECTION OF DIFFERENT MEALS FOR BREAKFAST AND DINNER?

A: Breakfast will be buffet style including healthy food as vegetables, cereals, fruits etc. however for dinner you can choose from a selection of 3 different set-menus and you still can place special orders from a wide variety of dishes!

---

Q: CAN I START AS A RESIDENT AT ANY TIME OR DO I HAVE TO WAIT FOR THE FIRST OF A MONTH ETC.?

A: You are welcome as a resident at any time of your choice!

---

Q: CAN I PARK MY CAR OR MOTORBIKE WITHIN THE RESIDENCE?

A: Two parking spaces for cars and motorbikes are available at the administration building and near to the terrace houses, free of charge!

---

Q: CAN I DRIVE WITH MY OWN CAR OR MOTORBIKE TO MY APARTMENT OR HOUSE?

A: Driving within the residence is not permitted; transportation is by electric-driven vehicle operated by a driver from the residence only!

---

Q: IS TRANSPORTATION WITHIN THE RESIDENCE COMPOUND (ELECTRIC-DRIVEN CARTS) AVAILABLE AT ALL TIME?

A: Free transportation is available from 6.00 am to 10.00 pm every day; however in case of emergency transportation can be arranged by the residence office at any time; charges may apply except for Platinum Member Card holder!

---

Q: CAN I BRING A PET?

A: Unfortunately because of the set-up of the residence and probably impeded mobility of other residents pets are not allowed!

---

Q: WHAT WILL HAPPEN IF I REQUIRE MORE SERVICE AND HAVE TO CHANGE MY MEMBER CARD?

A: Residents can change for example from Classic to Silver, Gold or Platinum Card Member at the end of any month!

---

Q: ARE RESTAURANTS AND SHOPS OPEN EVERY DAY?

A: Yes they are open every day; 365 days a year!

---

Q: CAN I BRING MY OWN FURNITURE WITH ME TO THE APARTMENT OR HOUSE?

A: Apartment and houses are fully furnished however pictures and smaller or decorative items can be brought!

---

Q: CAN FRIENDS OR FAMILY MEMBER VISIT ME AND STAY WITH ME?

A: They can either stay at your own unit provided you have space or in one of the DIFFERENCE guest apartments which will however depend on availability.

---

Q: WILL BREAKFAST AND DINNER BE SERVED ONLY AT A FIXED TIME OR CAN I HAVE IT WHENEVER I WANT?

A: Breakfast will be served from 07.00 to 10.30 am and dinner from 6.30 to 8.30 pm!

# REHABILITATION CENTER

Physical medicine and rehabilitation (PM&R), also known as physiatry, is a branch of medicine devoted to the prevention, diagnosis and treatment of neurologic, musculoskeletal, cardiovascular, pulmonary and other disorders that may produce temporary or permanent impairment and associated functional disability. PM&R provides care for a broad spectrum of disorders including multiple trauma, brain injury, spinal cord disorders and injuries and stroke. PM&R also focuses on restoring function to people with problems ranging from physical mobility limitations to those with complex cognitive impairments. PM&R physicians may have specialty or fellowship training to treat children, as well as adults. Lots of diseases within a rehabilitation program needs a physiatrist. In Thailand not very common, so we will have enough physiatrists from different countries (special Germany, Finland and Switzerland) to do continuous rehabilitation with overnight programs. So you always find the physiotherapist of your choice in our REHAB Center.



For example our Pulmonary Rehabilitation Program has a multidisciplinary team of specialists who provide rehabilitative care to people with chronic pulmonary disease and their families. The team includes pulmonary physicians and respiratory therapists. Physical therapists, occupational therapists, and dietitians who have expertise in the care of patients with chronic pulmonary disease may also be called on as needed.



While predicting the future is by its nature challenging, one thing all the above predictions have in common is that the developments are made possible by the advances in technology and the emergence of new collaborations and partnerships. We believe that 2018 is truly at a tipping point with new opportunities to deliver solutions that diagnose needs and inform care decisions, improve care delivery, and enable more comprehensive care manage for you.

We strongly emphasize, that we will work together with every hospital in Thailand to get the best cooperation in continuous rehabilitation programs and health rehabilitation.



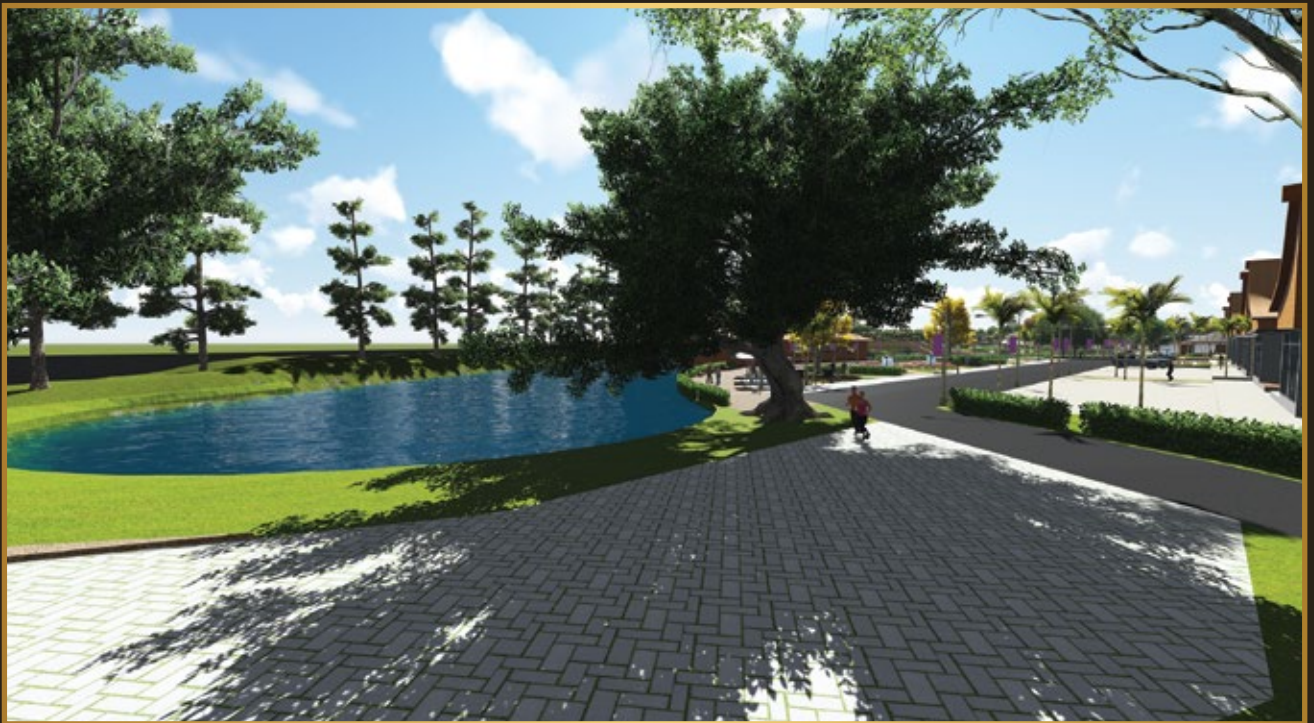

# THE EXPERT PROGRAM

One of our most important concerns is the utilization of your knowledge. We do not believe that your knowledge, which you have successfully used in your profession, is simply not taken into account. For all those who want to continue working in their old profession, we have opportunities to work together with you. This means that your work can be realized both within and outside the residence. So we can need engineering knowledge in our extensive eco-tools, eco-farming knowledge for our organic farming or teacher training to support Thai students. The list can be greatly expanded.

Of course, all those who need the peace and relaxation and have worked long enough have our greatest respect and will be able to enjoy our service. It is only the fact that you should feel that your professional experience is accepted, if you wish, because the greatest asset of our society is the experience of the elderly people.

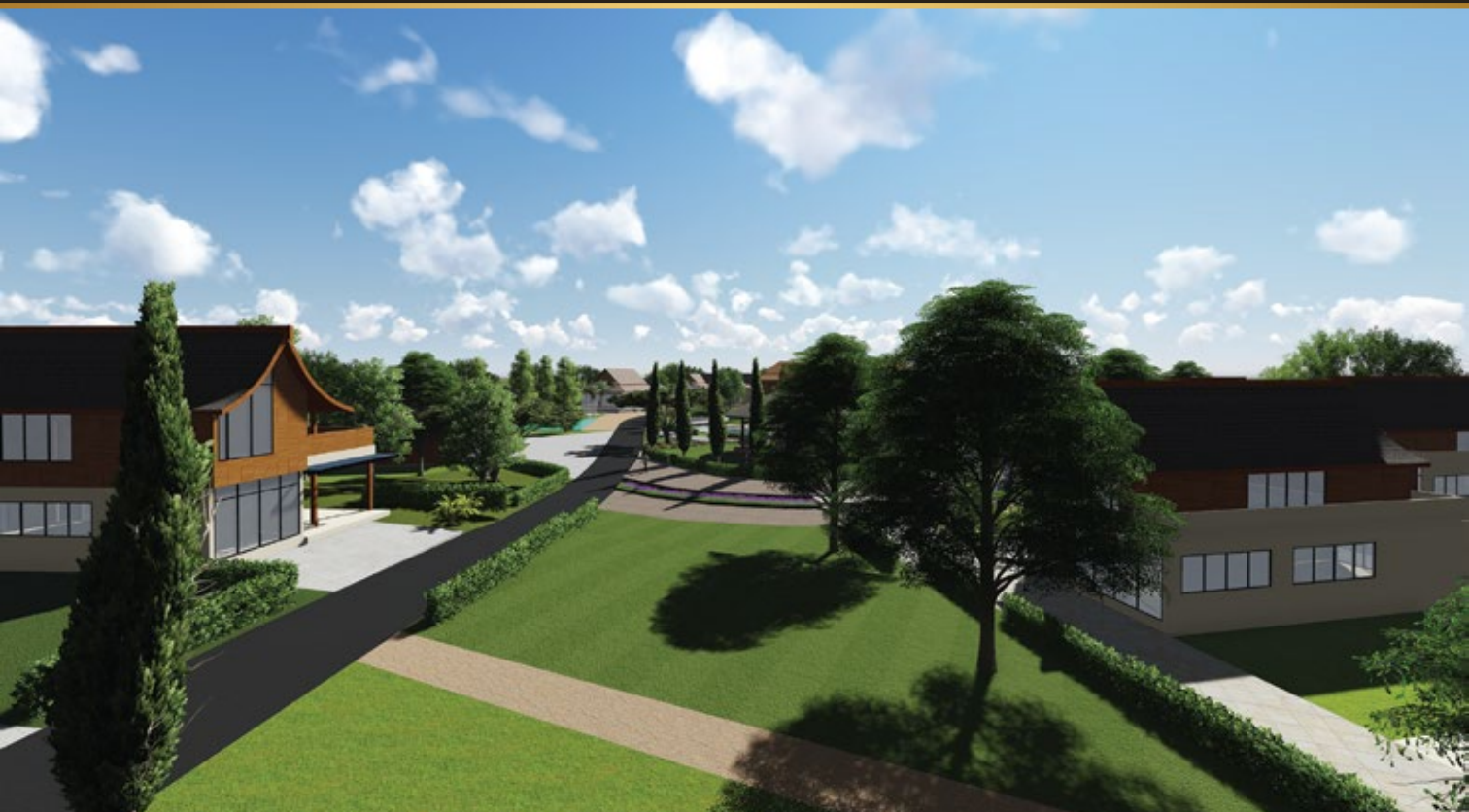

# SIAM SQUARE



# APARTMENTS

Apartment complex consisting of two 4-storey apartment buildings (A and B) with 150 units and 3 different sizes of apartments and twenty 3-storey buildings (C); a combination of terrace houses and apartments with 200 terrace houses and 160 apartments of 42 sqm each; however two 42 square meter apartments can be modified to one unit to have more living space.

Each apartment building has a roof garden accessible only for residents living in that building.

Every apartment is beautifully furnished and bright and well lit and has individual controlled air-conditioning; balconies are decorated with flowers and small plants.

All apartments are suitable for handicapped residents and are equipped with emergency buttons in the living area, balcony, bathroom and beside the bed. Health and smoke detector and sprinkler system are in every apartment. Safety Rail bars in all bathrooms.

The apartments depending on the location within the apartment buildings are having either sea view, mountain view or garden view. Every apartments on the ground Floor has a private patio with direct access to the garden.



APARTMENT TYPE A1, B1  
(40 SQM.)



APARTMENT TYPE A2, B2  
(64 SQM.)



APARTMENT TYPE A3, B3  
(90 SQM.)



APARTMENT TYPE C  
(42 SQM.)

# TERRACE HOUSES

Terrace Houses are consisting of 2 storey's and residents have the choice of having their house on the ground Floor with direct access to the stream or 1st Floor accesable by elevator. Terrace houses are in groups of 20 houses and divided from the counterpart by a green zone of 3 meters to guarantee privacy and a 2 meter artificial stream fit for swimming. For safety reason this stream is only 1.25 meters deep however the total lenght is 1,000 meter.

Every Terrace House is beautifully furnished and bright and well lit and has individual controlled air-conditioning; well integrated into nature.

All Terrace Houses are suitable for handicapped residents and are equipped with emergency buttons in the living area, balcony, and bathroom and beside the bed. Heath and smoke detector, and sprinkler system are in every room. Safety rail bars in all bathrooms.

Terrace houses consisting of 90 square meter living area and build in a Mediterranean style are providing a spacious living room, 2 bedrooms, 2 bathrooms with shower cubicle, inbuilt European style kitchen, terrace with deck chairs and table facing a small artificial stream; and are fully furnished including beds, cabinets, sofa, TV, telephone, Internet, tables and chairs.



# VILLAS

Villas are built on a 10 Rai (16,000 sqm) land plot with a beautiful designed garden, swimming-pool with pool bar and deck chairs, providing luxurious living while protecting your privacy. Only 20 villas are available.

Villas consisting of 120 square meter living area, with spacious living room, two or three bedrooms, two bathrooms with shower cubicle, inbuilt European style kitchen, guest toilet, huge terrace with deck chairs and table facing the landscaped garden with a small artificial pond and plenty of flowers and small plants; fully furnished including beds, cabinets, sofa, TV, telephone, Internet, tables and chairs.

Every villa is beautiful furnished and bright and well lit and has individual controlled air-conditioning. All Villas are suitable for handicapped residents and are equipped with emergency buttons in the living area, terrace, and bathroom and beside the bed. Heath and smoke detector, and sprinkler system are in every room. Safety rail in all bathrooms.

**All Villas are fitted with Rooftop Solar Panels!**

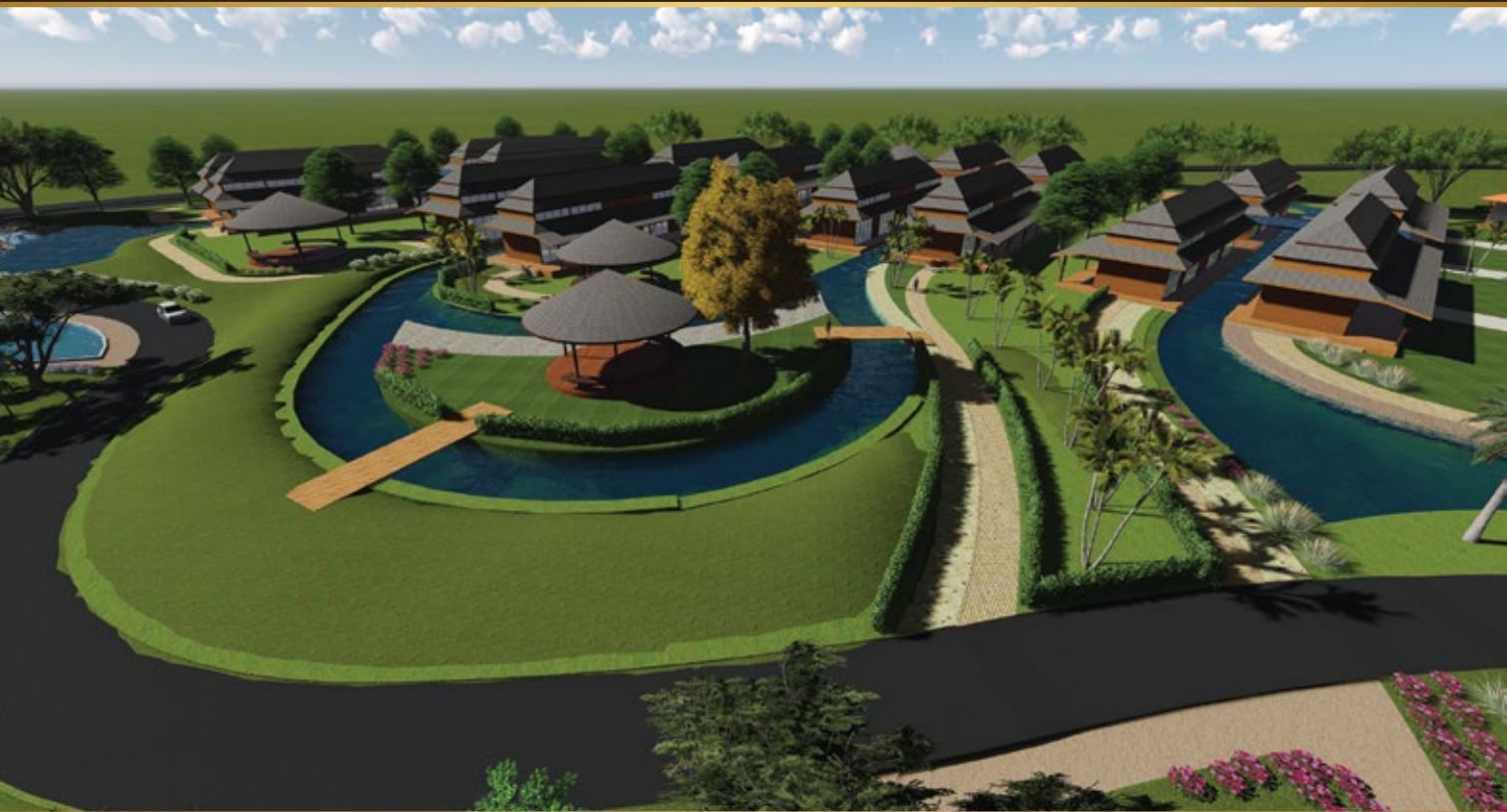

VILLA (120 SQM.)



SIAM GOLDEN AGE (THAILAND) CO., LTD.

**Tel.: +66-38-252531-2**

**Fax: +66-38-252533**

352/329 M. 12, Nongprue, Banglamung  
Chonburi 20150, Thailand

[WWW.DIFFERENCERESIDENCE.COM](http://WWW.DIFFERENCERESIDENCE.COM)